

St. Nr.33+34 (1 : 2)

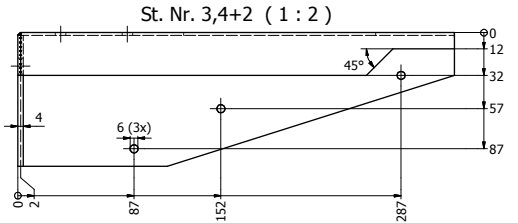

St. Nr. 3,4+2 (1 : 2)

Erst buigen daarna gaten agtekenen en boren
1 x links, 1 x rechts

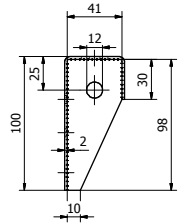
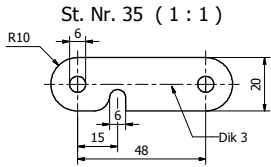

St. Nr. 35 (1 : 1)

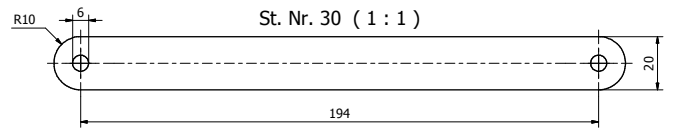

St. Nr. 30 (1 : 1)

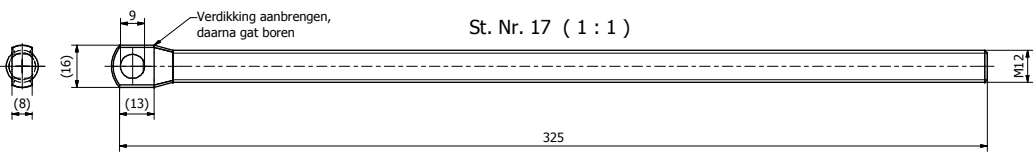

St. Nr. 17 (1 : 1)

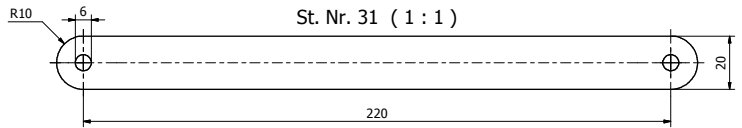

St. Nr. 31 (1 : 1)

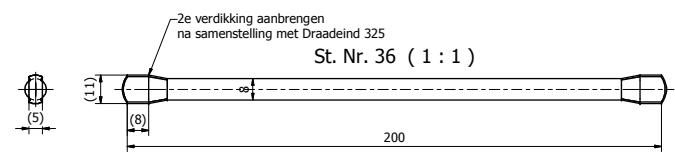

St. Nr. 36 (1 : 1)

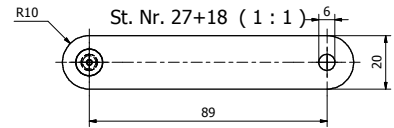

St. Nr. 27+18 (1 : 1)

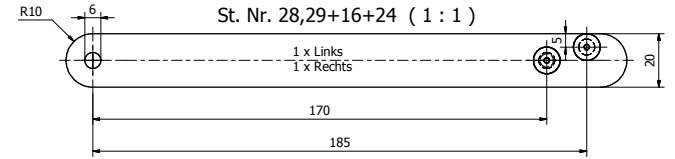

St. Nr. 28,29+16+24 (1 : 1)

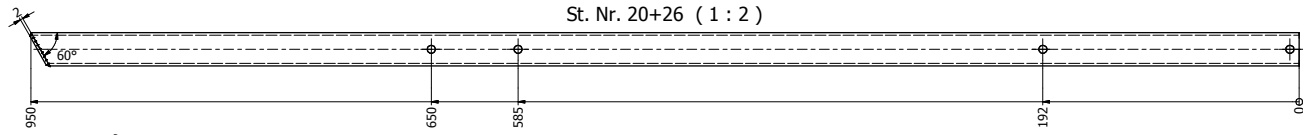

St. Nr. 20+26 (1 : 2)

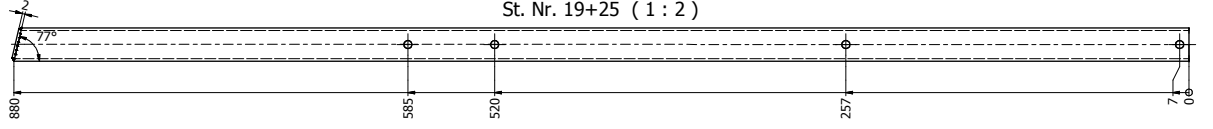

St. Nr. 19+25 (1 : 2)

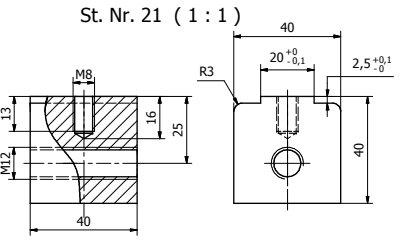

St. Nr. 21 (1 : 1)

RIJWEG VOLGENS NEN 363A	ISO-PASSENEN NEN-ISO 286-1 EN-2	GETEKEND Phil Truijthuis	PLAATS LEERLING NUMMER
AMERKAANSE PROJECTIE	SCHAAL 1 : 2	KLAS	VOLG. DE PLAATSTOLERANTIES VOLGENS NEN-ISO 1101
	MAATENHIED MM	GEZEN	
ROCA 12	DATUM 11-6-2008	Benaming Work mate Onderdelen	Tekening Nr. 2 Formaat A1

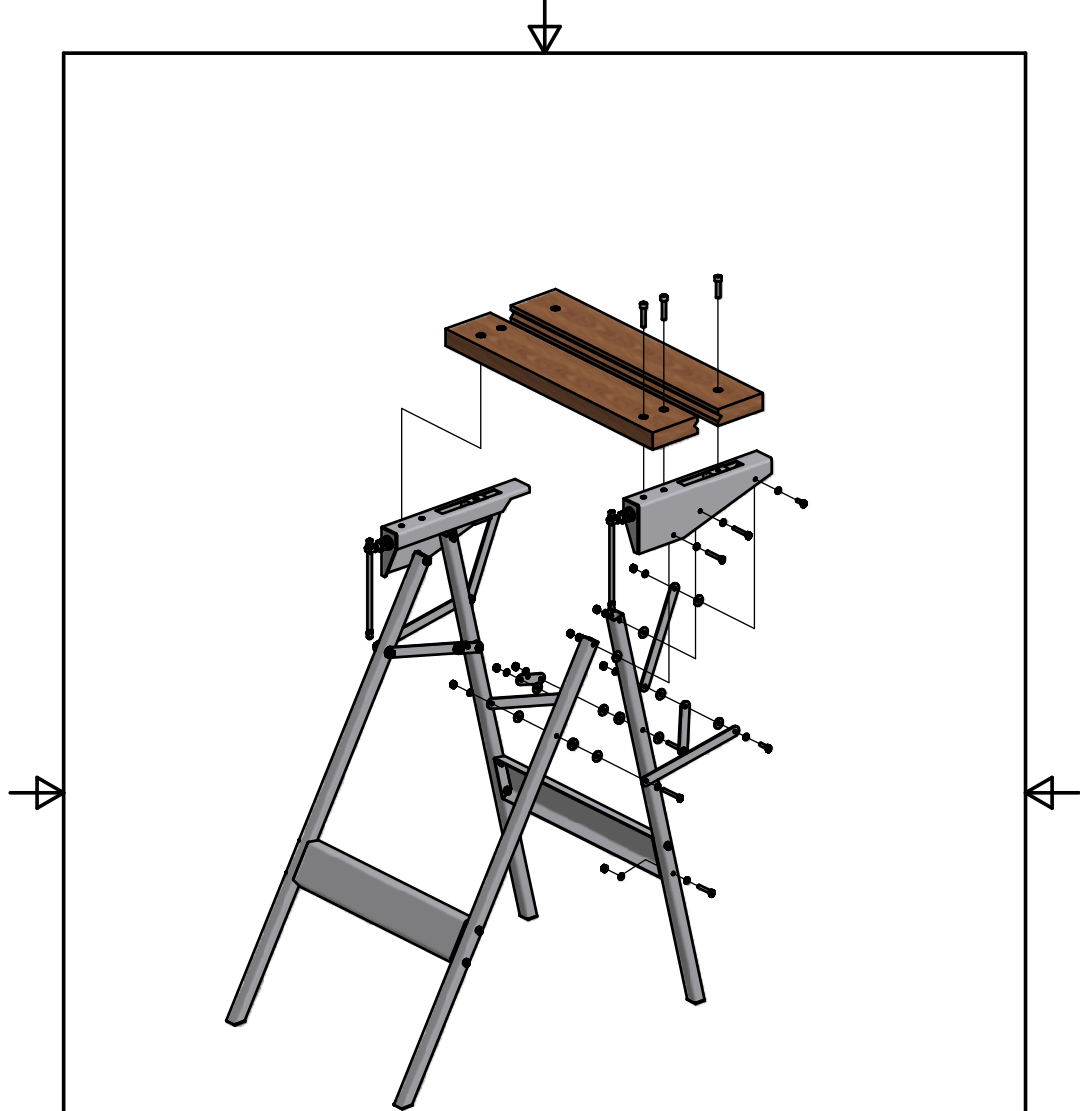

RUWHEID VOLGENS NEN 3634	ISO-PASSINGEN NEN-ISO 286-1 EN-2		● PLAATS LEERLING NUMMER
AMERIKAANSE PROJECTIE 	SCHAAL 1 : 10 MAATEENHEID MM DATUM 11-6-2008	GETEKEND Phil Trethewie KLAS GEZIEN	VORM- EN PLAATSTOLERANTIES VOLGENS NEN-ISO 1101
	Benaming Work mate Samenstelling		Tekening Nr. 3 Formaat A4